

Holly Davey

08/09/02

**Into the Light Details**

**Artist:** Jonas, Joan

**Title:** Mirage

**Date:** 1970

**Sound:** yes

Two Video Projections and two videotapes transferred to DVD

**Duration:** Continuous Projection

**Dimenisions :**

25ft x 25ft size of room

**Equipment Required:**

- 1 Sony PVM 2530 25" monitor
- 2 Epson Power Lite LCD Video Projector: with remote
- 1 Sony STR - DE935 Amplifier
- 3 Pioneer V7400 DVD Player
- 2 JBL Control25 Speakers
- 1 Sony Speaker

**Color of Walls:** Dark Grey

**Screen Dimensions:**

Fill the walls

**Type of Screen:**

Wall

**Notes**

Monitor is on its narrow side.  
Light lock required

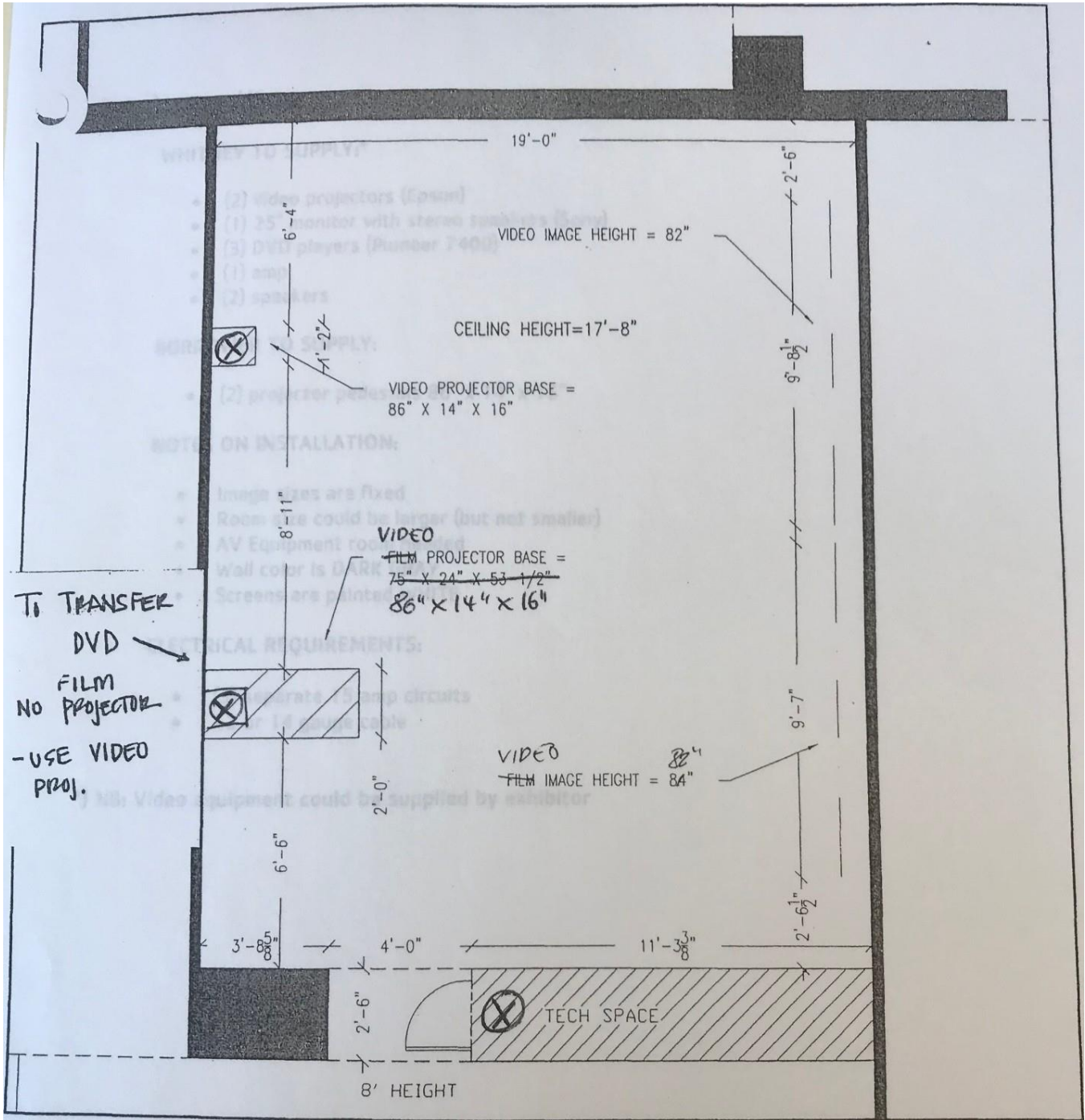

•N JONAS FLOOR PLAN

SCALE: 1/4"=1'-0"

|   |  |
|---|--|
| <p>If It's In The Light<br/>         PHITNEY KÇSEUM OF AXERIMAX ART</p> |  |
|---|--|

WHITNEY 70 SUPPLY

- » (2) video protectors (Spsos)
- « (y) 25" monltor w(th stera0 ¥
- . (3j DvD piayers (Ptonesr 7400)
- (l} amp
- » (2) speakers

BORROWER TO SUPPLY:

- [2] projector pedestals 86" x 14" x 7g°

NOTES ON INSTALLATION

- Image sizes are fixed
- Room size could be larger (but apt
- AV Equipment room needed
- Wall color is DARX 6RAY
- Screens are painted @HITE

ELECTRICAL REQUIREMENTS

- 12 or 14 gauge cable

**\*) NB: Video equipment could be supplied by exhibitor**